

PAC 40



The open blanks of board are loaded onto the automatic pile hoist which rises through a photocell reading. A series of suction pads lift and carry the top blank into the infeed rollers, and the blank then enters the folding section.

Once folded, the chain driven stops push the case towards the stitching or gluing head, but before the actual stitching or gluing operation the case is squared up to moving front stops. The case remains gripped securely between the front and back stops as it is carried through the stitching or gluing head, thus eliminating any fish-tailing.

The stitching head is equipped with the very latest dual oscillating head for both single and double wall board, powered by a brushless motor. The maximum mechanical speed of this head is 1200 stitches/minute.

Once stitched, the cases are delivered into the stacker ejector, which can now be offered with a squaring device to allow PVA cold gluing on the machine as well as stitching or hot melt gluing.

All main mechanical adjustments on the machine are motorised and controlled from a hand-held control panel. A simple micro-processor controls the stitch spacing. The micro-processor can hold 50 job programs in memory. A typical job change will take less than 10 minutes.

The micro-processor will calculate automatically the position of the stitches regardless of the travelling speed of the cases.

The overall size of the machine is extremely compact:

5.4 metres (l) x 4.8 metres (w)	without batch stacker
10 metres (l) x approx. 4.8 metres (w)	with batch stacker

SPECIFICATION

Maximum width of blank	3800 mm	
Minimum width of blank	800 mm	
Maximum length of blank	1600 mm	
Minimum length of blank	300 mm	
Maximum length of large panel	800 mm	
Maximum width of large panel	1100 mm	1070
Minimum width of large panel	230 mm	235
Minimum width of small panel	170 mm	190
Stitching speed (maximum)	1200/minute	
Cycle speed	Up to 1800 cases/hour	
Power supply (stitching)	12 kva	
(stitching & hot melt)	18 kva	15000 20000

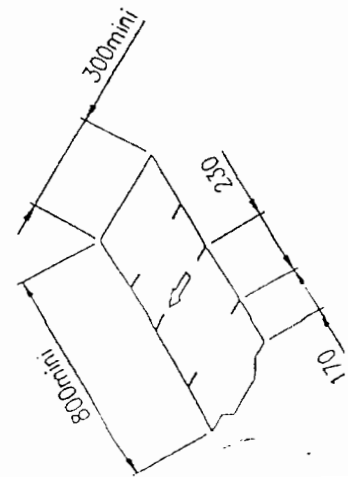
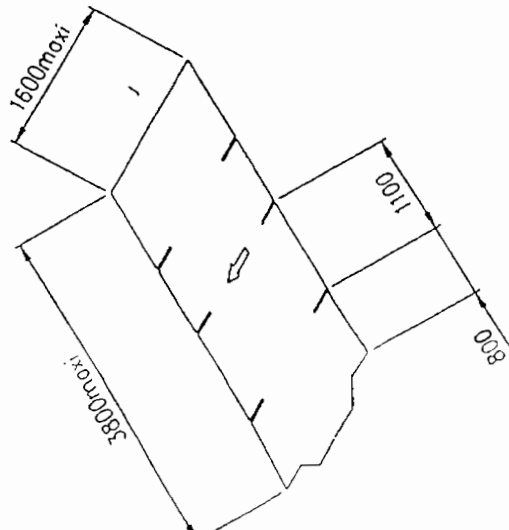
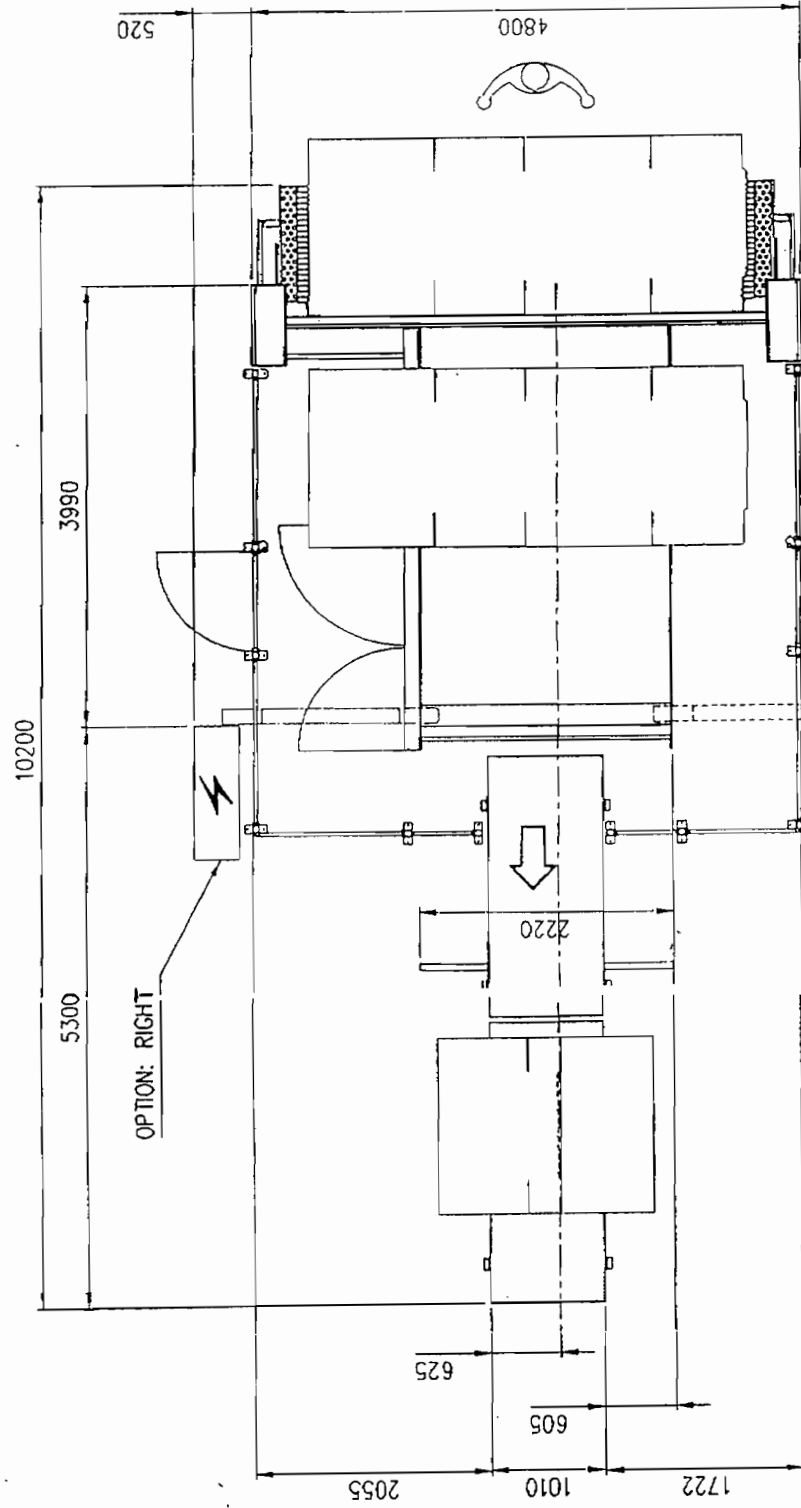
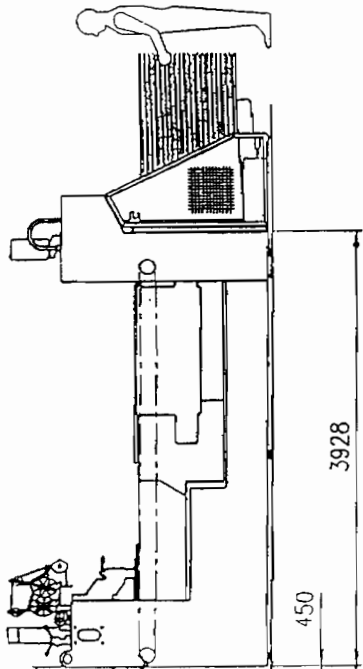
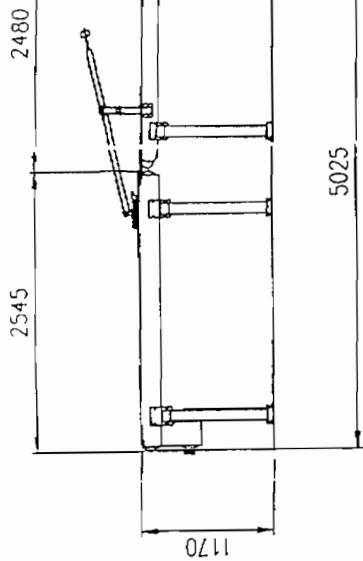
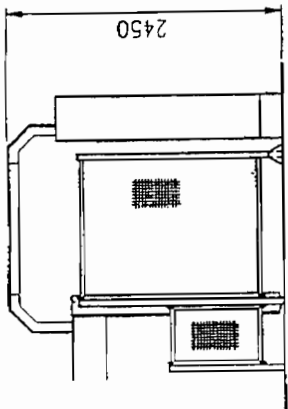

N°	DESIGNATION	KW	m ³ /hr
PAC40		17	35

AIR C VOLUME

LISSANCE

SODEME

NOTICE

PAC40

1/5

Ce plan est la propriété de la S.A.SODEME à ne pas être reproduit sans autorisation.